

VYTYČOVACÍ VÝKRES - SO 101
1:500

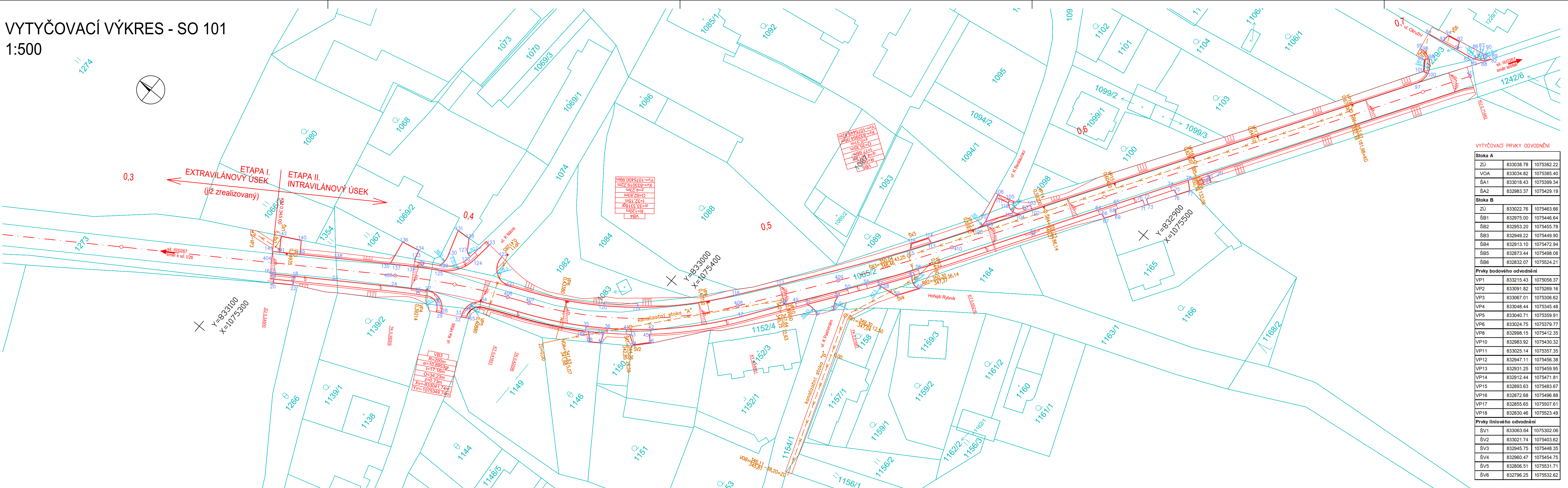

VYTYČOVACÍ PRVKY ODVODNĚNÍ

| | | |
|---------|-----------|------------|
| Stoka A | | |
| ZÚ | 833038.78 | 1075382.22 |
| VOA | 833034.82 | 1075385.40 |
| ŠA1 | 833018.43 | 1075399.34 |
| ŠA2 | 832983.37 | 1075429.19 |

| | | |
|---------|-----------|------------|
| Stoka B | | |
| ZÚ | 833022.76 | 1075463.66 |
| ŠB1 | 832975.00 | 1075446.64 |
| ŠB2 | 832953.20 | 1075455.78 |
| ŠB3 | 832949.22 | 1075449.90 |
| ŠB4 | 832913.10 | 1075472.94 |
| ŠB5 | 832873.44 | 1075498.08 |
| ŠB6 | 832832.07 | 1075524.21 |

| | | |
|--------------------------|-----------|------------|
| Prvky bodového odvodnění | | |
| VP1 | 833215.43 | 1075058.37 |
| VP2 | 833091.82 | 1075269.16 |
| VP3 | 833067.01 | 1075306.62 |
| VP4 | 833048.44 | 1075345.48 |
| VP5 | 833040.71 | 1075359.91 |
| VP6 | 833024.75 | 1075379.77 |
| VP8 | 832998.15 | 1075412.35 |
| VP10 | 832983.92 | 1075430.32 |
| VP11 | 833025.14 | 1075357.35 |
| VP12 | 832947.11 | 1075456.38 |
| VP13 | 832931.25 | 1075459.95 |
| VP14 | 832912.44 | 1075471.81 |
| VP15 | 832893.63 | 1075483.67 |
| VP16 | 832872.68 | 1075496.88 |
| VP17 | 832855.65 | 1075507.61 |
| VP18 | 832830.46 | 1075523.49 |

| | | |
|---------------------------|-----------|------------|
| Prvky liniového odvodnění | | |
| ŠV1 | 833063.64 | 1075302.06 |
| ŠV2 | 833021.74 | 1075403.62 |
| ŠV3 | 832945.75 | 1075448.35 |
| ŠV4 | 832960.47 | 1075454.75 |
| ŠV5 | 832806.51 | 1075531.71 |
| ŠV6 | 832796.25 | 1075532.62 |

| | | |
|----------------------|-------------|------------|
| VYTYČOVACÍ PRVKY OSY | | |
| ČÍSLO BODU | X | Y |
| 400 | 1074998.521 | 833225.237 |
| 401 | 1075046.976 | 833210.003 |
| 402 | 1075072.016 | 833201.767 |
| 403 | 1075114.580 | 833187.142 |
| 404 | 1075175.972 | 833156.873 |
| 405 | 1075335.438 | 833051.216 |
| 406 | 1075365.447 | 833034.838 |
| 407 | 1075371.554 | 833032.154 |
| 408 | 1075420.016 | 832993.301 |
| 409 | 1075438.356 | 832968.316 |
| 410 | 1075458.251 | 832939.101 |
| 411 | 1075545.000 | 832801.500 |

| | | |
|--------------------|------------|-----------|
| INFORMACE O BODECH | | |
| ČÍSLO BODU | X | Y |
| 16 | 1075306.30 | 833074.37 |
| 17 | 1075306.02 | 833074.02 |
| 18 | 107312.63 | 833070.22 |
| 19 | 1075308.79 | 833075.04 |
| 20 | 1075308.79 | 833076.11 |

| | | |
|--------------------|-------------|------------|
| INFORMACE O BODECH | | |
| ČÍSLO BODU | X | Y |
| 81 | 1075505.767 | 832872.169 |
| 82 | 1075546.568 | 832793.727 |
| 83 | 1075541.578 | 832797.089 |
| 84 | 1075527.390 | 832799.680 |
| 85 | 1075542.630 | 832796.659 |
| 86 | 1075543.094 | 832795.256 |
| 87 | 1075542.855 | 832794.049 |
| 88 | 1075545.475 | 832794.863 |
| 89 | 1075544.277 | 832794.279 |
| 90 | 1075544.083 | 832793.804 |
| 91 | 1075537.080 | 832797.755 |
| 92 | 1075536.005 | 832795.366 |
| 93 | 1075531.984 | 832798.686 |
| 94 | 1075532.209 | 832796.123 |
| 95 | 1075528.267 | 832804.496 |
| 96 | 1075528.835 | 832804.453 |
| 97 | 1075534.093 | 832813.176 |
| 98 | 1075532.002 | 832805.305 |
| 99 | 1075531.329 | 832806.353 |
| 100 | 1075534.700 | 832808.970 |

| | | |
|--------------------|-------------|------------|
| INFORMACE O BODECH | | |
| ČÍSLO BODU | X | Y |
| 21 | 1075313.09 | 833071.72 |
| 22 | 1075313.78 | 833072.77 |
| 23 | 1075322.43 | 833063.73 |
| 24 | 1075337.233 | 833053.925 |
| 25 | 1075343.905 | 833050.690 |
| 26 | 1075339.636 | 833043.689 |
| 27 | 1075345.909 | 833048.496 |
| 28 | 1075353.036 | 833050.809 |
| 29 | 1075353.162 | 832981.099 |
| 30 | 1075350.013 | 833048.958 |
| 31 | 1075358.773 | 833044.276 |
| 32 | 1075358.469 | 833048.261 |
| 33 | 1075358.176 | 832976.038 |
| 34 | 1075360.892 | 833040.505 |
| 35 | 1075389.012 | 833026.730 |
| 36 | 1075394.347 | 833023.176 |
| 37 | 1075390.496 | 833027.386 |
| 38 | 1075392.768 | 833029.658 |
| 39 | 1075394.372 | 833024.804 |
| 40 | 1075395.562 | 833027.760 |

| | | |
|--------------------|-------------|------------|
| INFORMACE O BODECH | | |
| ČÍSLO BODU | X | Y |
| 101 | 1075533.363 | 832809.302 |
| 102 | 1075469.523 | 832915.314 |
| 103 | 1075468.375 | 832914.604 |
| 104 | 1075467.777 | 832918.365 |
| 105 | 1075462.249 | 832917.200 |
| 106 | 1075458.870 | 832918.110 |
| 107 | 1075460.980 | 832926.180 |
| 108 | 1075460.372 | 832930.111 |
| 109 | 1075461.101 | 832926.799 |
| 110 | 1075465.736 | 832919.446 |
| 111 | 1075459.162 | 832919.222 |
| 112 | 1075462.801 | 832918.243 |
| 113 | 1075452.695 | 832941.952 |
| 114 | 1075450.901 | 832941.378 |
| 115 | 1075449.008 | 832947.579 |
| 116 | 1075447.962 | 832945.931 |
| 117 | 1075425.670 | 832980.530 |
| 118 | 1075417.396 | 832991.378 |
| 119 | 1075396.970 | 833012.074 |
| 120 | 1075388.897 | 833018.132 |

| | | |
|--------------------|-------------|------------|
| INFORMACE O BODECH | | |
| ČÍSLO BODU | X | Y |
| 41 | 1075398.894 | 833019.814 |
| 42 | 1075404.542 | 833015.158 |
| 43 | 1075400.514 | 833020.323 |
| 44 | 1075403.534 | 833022.173 |
| 45 | 1075405.136 | 833016.498 |
| 46 | 1075407.110 | 833018.270 |
| 47 | 1075422.635 | 832995.224 |
| 48 | 1075430.510 | 832984.080 |
| 49 | 1075432.620 | 832981.458 |
| 50 | 1075442.094 | 832968.540 |
| 51 | 1075435.887 | 832979.541 |
| 52 | 1075440.065 | 832980.093 |
| 53 | 1075442.892 | 832976.038 |
| 54 | 1075441.229 | 832972.260 |
| 55 | 1075445.457 | 832963.863 |
| 56 | 1075454.595 | 832950.555 |
| 57 | 1075448.856 | 832961.644 |
| 58 | 1075449.854 | 832961.430 |
| 59 | 1075454.700 | 832960.730 |
| 60 | 1075458.619 | 832954.807 |

| | | |
|--------------------|-------------|------------|
| INFORMACE O BODECH | | |
| ČÍSLO BODU | X | Y |
| 61 | 1075454.514 | 832953.379 |
| 62 | 1075474.378 | 832920.739 |
| 63 | 1075467.865 | 832916.632 |
| 64 | 1075484.819 | 832902.865 |
| 65 | 1075487.848 | 832898.061 |
| 66 | 1075486.325 | 832903.102 |
| 67 | 1075487.806 | 832903.581 |
| 68 | 1075488.716 | 832899.308 |
| 69 | 1075489.813 | 832900.450 |
| 70 | 1075493.256 | 832892.108 |
| 71 | 1075494.613 | 832892.962 |
| 72 | 1075493.875 | 832891.126 |
| 73 | 1075495.240 | 832891.988 |
| 74 | 1075496.923 | 832883.666 |
| 75 | 1075498.476 | 832883.828 |
| 76 | 1075500.055 | 832884.477 |
| 77 | 1075502.315 | 832880.953 |
| 78 | 1075499.954 | 832878.859 |
| 79 | 1075503.487 | 832876.298 |
| 80 | 1075504.554 | 832874.606 |

| | | |
|--------------------|-------------|------------|
| INFORMACE O BODECH | | |
| ČÍSLO BODU | X | Y |
| 141 | 1075304.523 | 833067.800 |
| 142 | 1075301.800 | 833063.690 |
| 143 | 1075302.718 | 833068.974 |

| | | |
|--------|-------|-------|
| 03 | | |
| 02 | | |
| 01 | | |
| REVIZE | POPIS | DATUM |

OBJEDNATEL
SPRÁVA A ÚDRŽBA SILNIC
PLZEŇSKÉHO KRAJE
Škroupova 18, 306 13 Plzeň
tel.: +420 377 195 353, email:
gosta@suspk.eu
internet: www.suspk.eu



| | | | |
|---|--|-------------------------|---|
| SAGASTA s.r.o. SÍDLA: NOVODVORSKÁ 1010414, 142 00 PRAHA 4 IČ: 045 98 555 | | JTSK ČÍSLO SOUPRAVY | |
| ODPOVĚDNÝ PROJEKTANT ING. LENKA HORÁLKOVÁ <i>Horálková</i> | VYPRACOVAL ING. LENKA HORÁLKOVÁ <i>Horálková</i> | KONTROLA <i>Hyk</i> | HIP ING. LENKA HORÁLKOVÁ <i>Horálková</i> |
| OBSAH III/0267 ČERVENÝ ÚJEZD (POKRAČOVÁNÍ) ETAPA II. INTRAVILÁNOVÝ ÚSEK | | ČÍSLO ZAKÁZKY 119081 | ČÍSLO SOUPRAVY Bpv |
| NÁZEV ČÁSTI GEODETICKÁ DOKUMENTACE | | DOKUMENTACE PDPS | MEŘITKO 1:500 |
| NÁZEV PŘÍLOHY VYTYČOVACÍ VÝKRES - SO 101 | | DATUM 12/2020 | POČET FORMÁTŮ 7 x A4 |
| DOKUMENTACE LZE UŽÍVAT POUZE VE SMYSLU PŘÍSLUŠNÉ SMLOUVY O DÍLO, JEHO ČÁSTI, NĚŽE BYT KOPÍROVÁN NEBO JINÝM ZPŮSOBEM ROZŠŘOVÁN POUZE PO PŘEDCHOZÍ SOHLASĚ SAGASTA s.r.o. | | ČÁST E.1 | ČÍSLO PŘÍLOHY 2 |